

15 | entry scale: 1/4" = 1'-0"

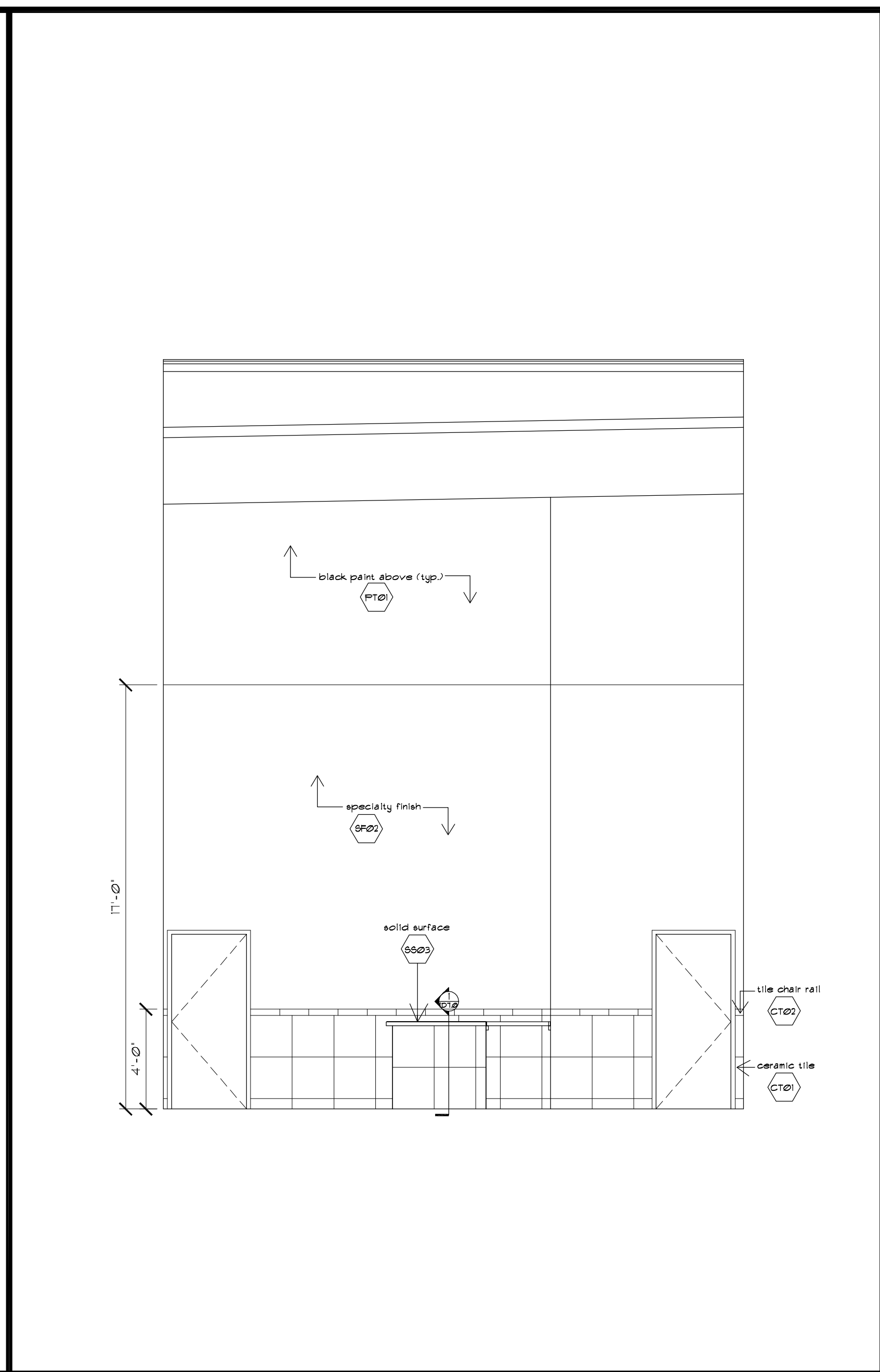

11 | entry scale: 1/4" = 1'-0"

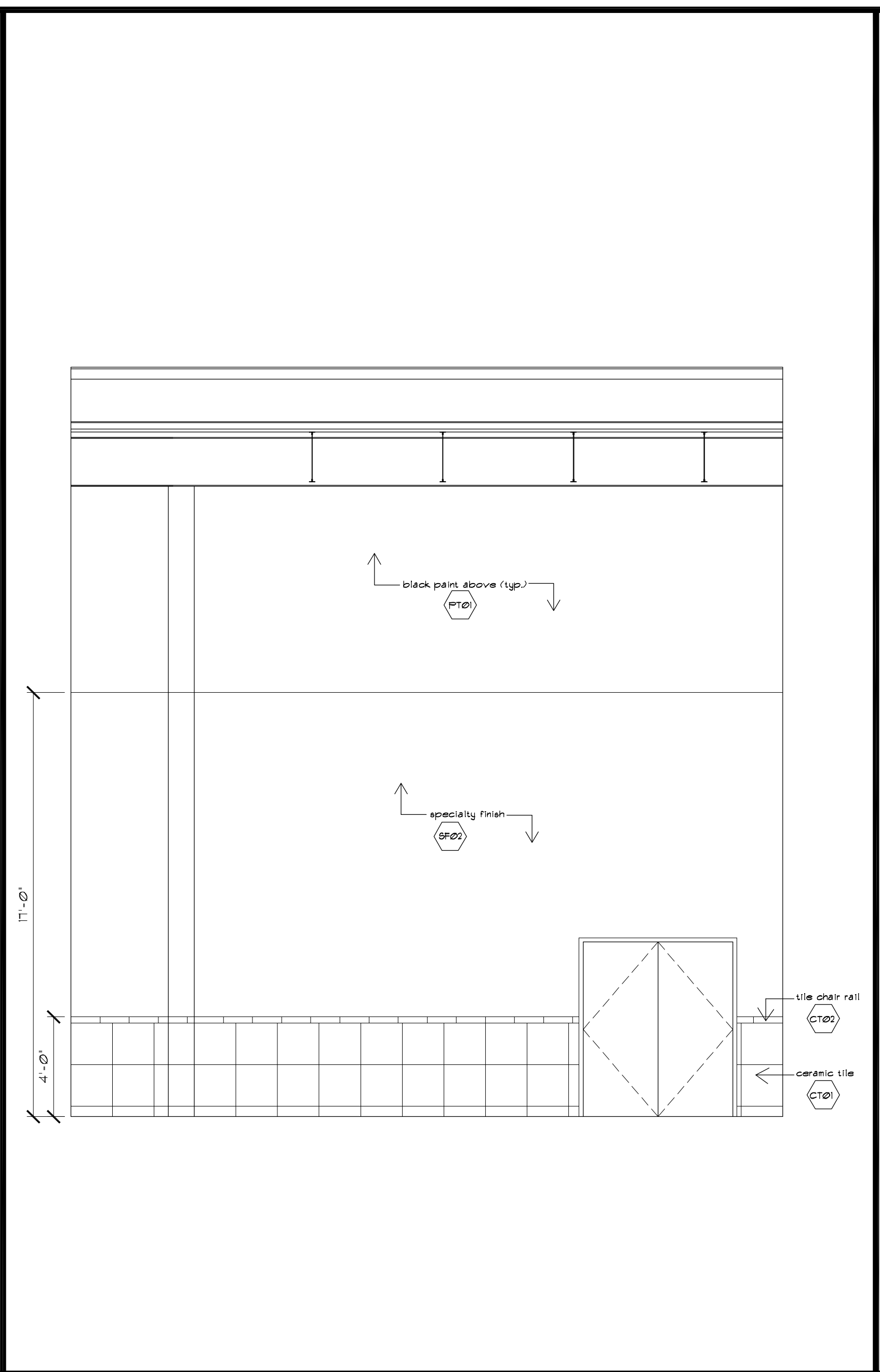

7 | entry scale: 1/4" = 1'-0"

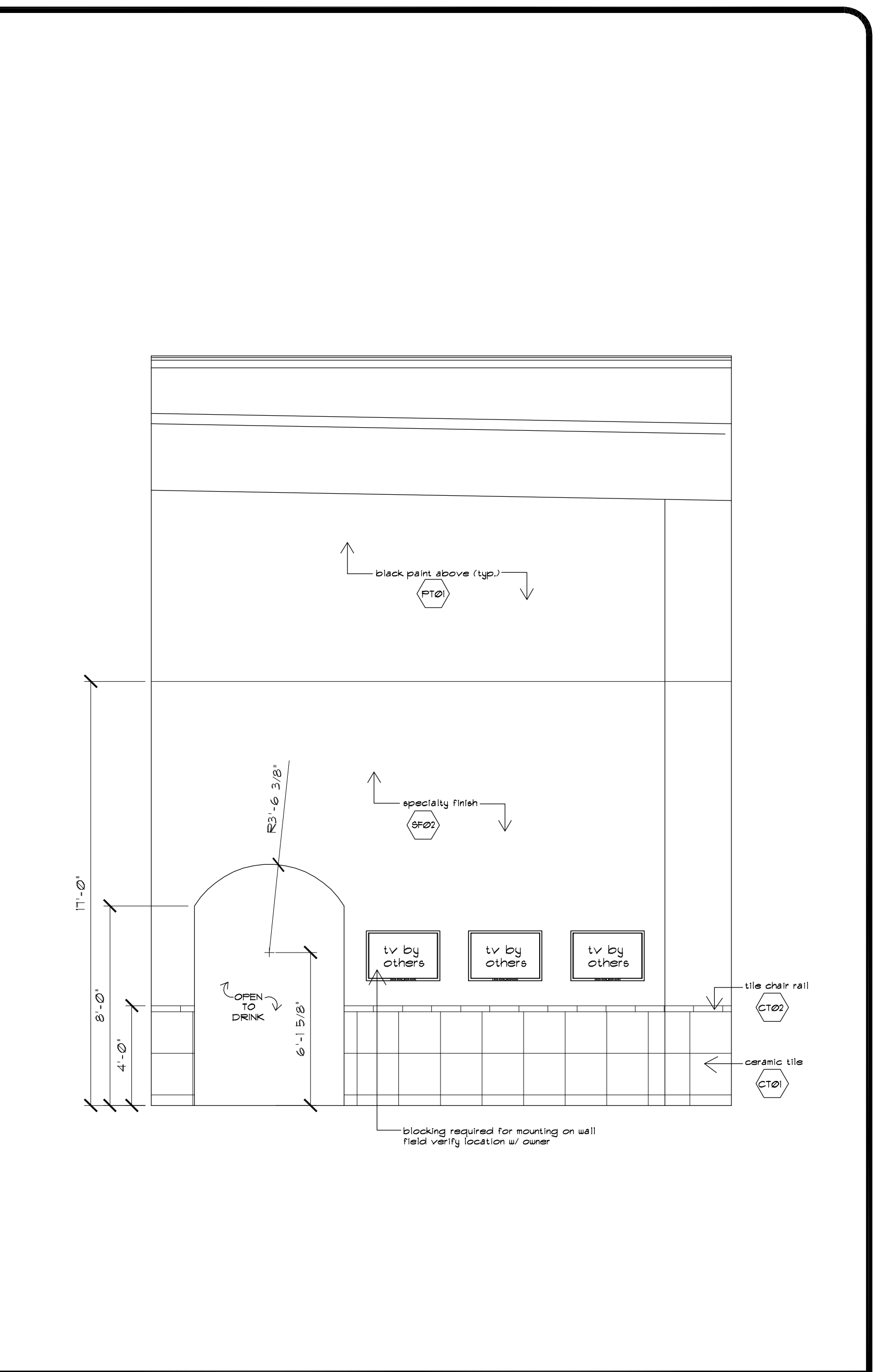

3 | entry scale: 1/4" = 1'-0"

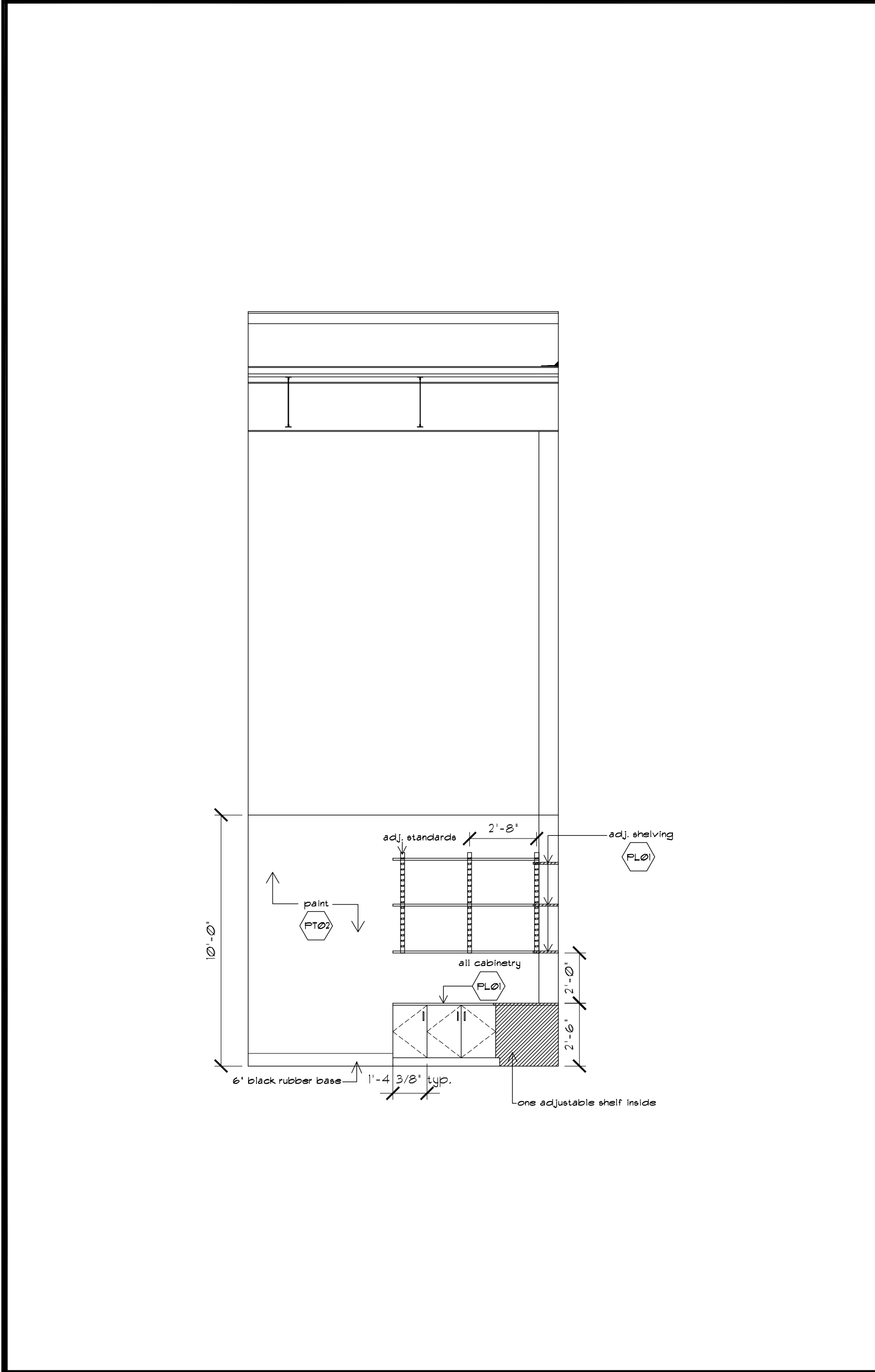

13 | promo office scale: 1/4" = 1'-0"

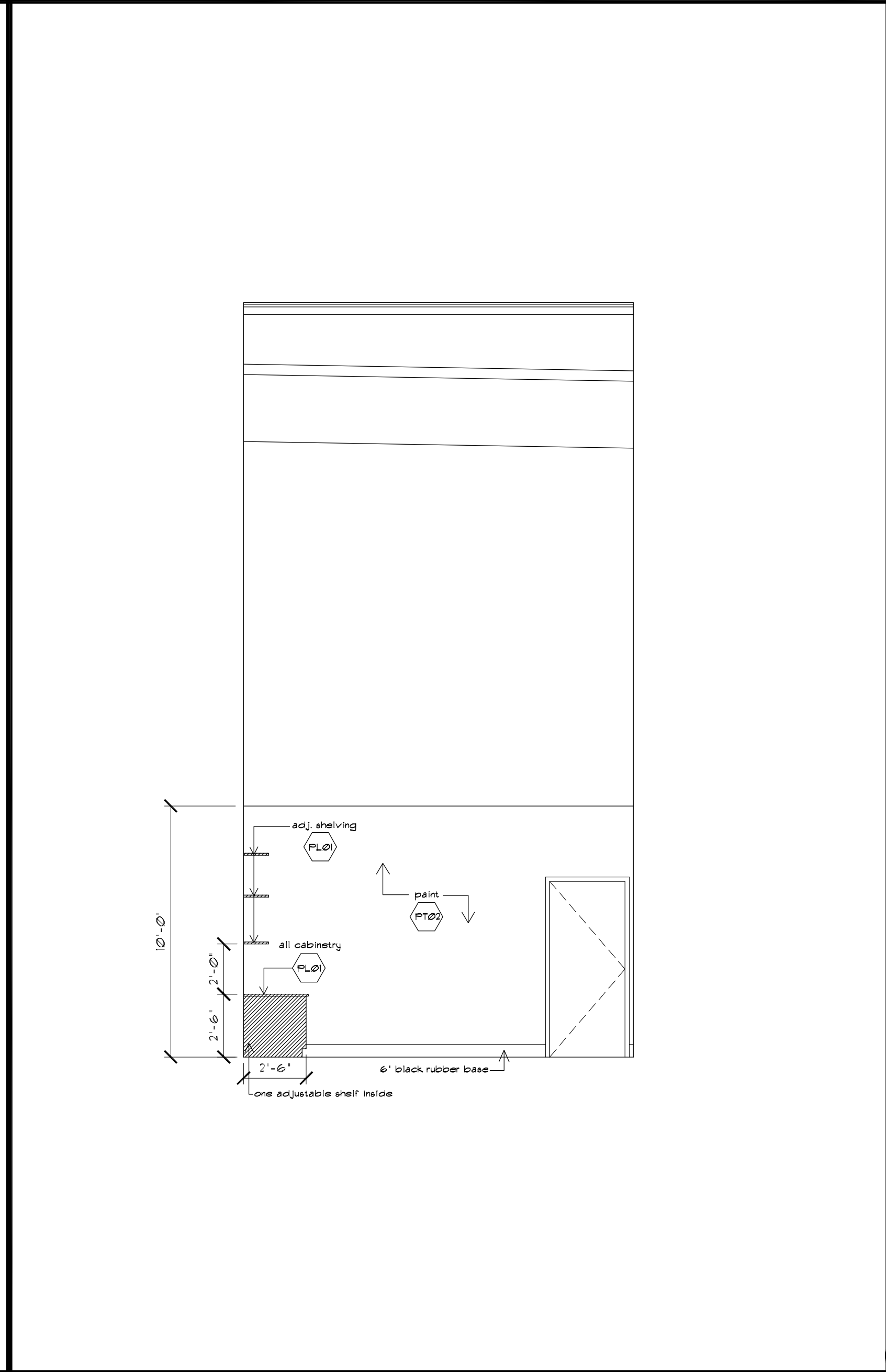

9 | promo office scale: 1/4" = 1'-0"

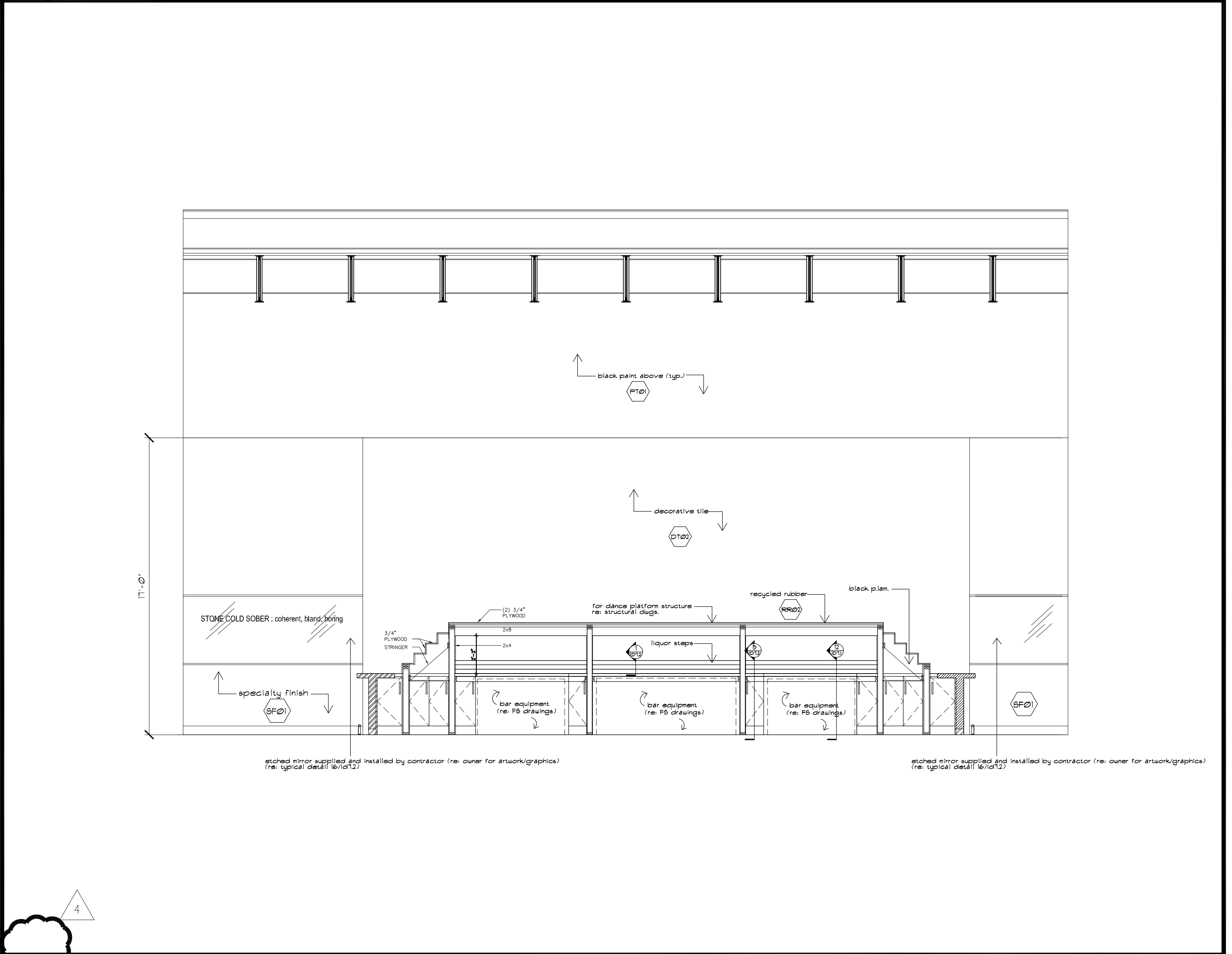

5 | drink backbar scale: 1/4" = 1'-0"

REVISION #04 - August 27, 2009  
 Architect Comments

**batsche design**  
 448 w. 19th st. #330  
 Houston, TX 77008  
 t 713.527.0074  
 f 713.527.8065

**Hermes Architects**

Members A.I.A.  
 1177 West Loop South, Ste. 500  
 Houston, Texas 77027  
 Tel 713-785-3644  
 Fax 713-953-2515  
 www.hermesarchitects.com

INTERIOR DESIGNER: DAWN ARCIERI  
 REGISTRATION #: 3153  
 DATE: 05/15/09

**DRINK INTERIOR BUILD-OUT**  
 7620 KATY FREEWAY  
 BLDG 3B, SUITE 360  
 HOUSTON, TEXAS 77024

Fidelis Realty Partners  
 19 Briar Hollow Lane  
 Suite 100  
 Houston, TX 77027

DATE: december 08, 2009  
 PROJECT NO.: 700912  
 DRAWN BY: nicole williamson  
 CHECKED BY: dawn arcieri

interior elevations

id6.6